

C1bl

CANTILEVER DETAIL (Shear Soffit)

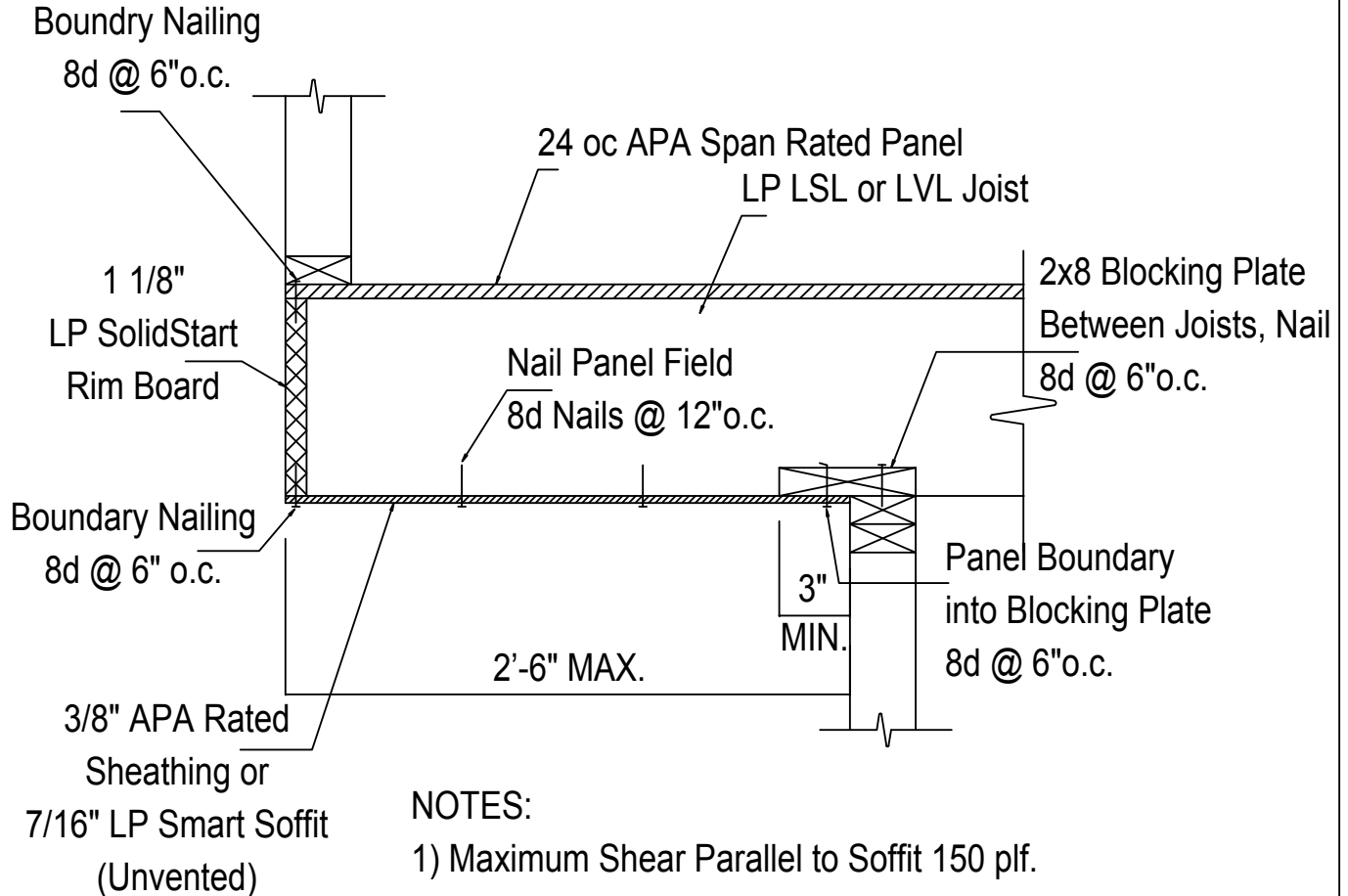

NOTES:

- 1) Maximum Shear Parallel to Soffit 150 plf.
- 2) Building Stability per Architect or Engineer of Record.
- 3) LP LSL or LVL Joist to be Designed to Carry Wall Load from above. Refer to Installation Instructions or Appropriate Technical Guide for the additional information.