

---

Design No. LPB/WPPS 60-01  
Loadbearing Wall Assembly  
LP Building Products  
LP® FlameBlock® Fire-Rated OSB Sheathing  
ASTM E-119  
Assembly Rating-1 hour  
Restricted Load - maximum 41.6% of design load<sup>1</sup>

---

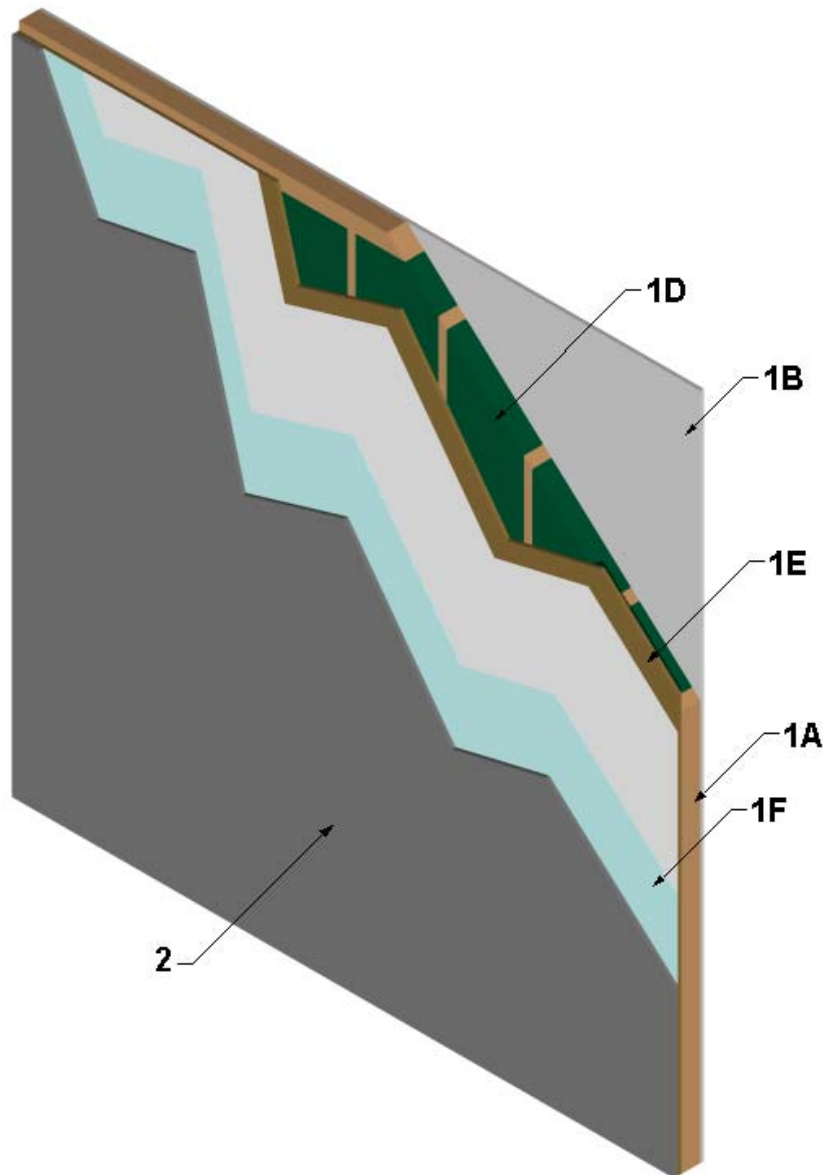

---

<sup>1</sup> Design Load calculated per sections 3.6 and 3.7 of ANSI/AF&PA NDS-05

1. WALL ASSEMBLY: Construct a 1 hour rated gypsum wall assembly using the following elements:

- A. WOOD STUDS: Install nominal 2 in. x 6 in., Number 2 Douglas Fir wood studs spaced 16 in. on center. Attach each wood stud to top and bottom wood plates using three (3) 16d framing nails at each location. Construct top plate of two (2) wood studs installed horizontally at the top of the gypsum wall assembly and the bottom plate of a single wood stud. Install nominal 2 in. x 6 in. wood studs horizontally as cross-bracing positioned at mid-height of the wall.
- B. GYPSUM BOARD: Install one layer of nominal 5/8 in. thick Type X gypsum board, oriented vertically. Secure gypsum board using nominal 1-7/8 in. long cup-head drywall nails spaced nominally 8 in. on center
- C. Joint Tape and compound (Not shown): Install vinyl or casein, dry or premixed joint compound applied to exterior face of gypsum board in two coats to all exposed fastener heads and gypsum board joints. Install minimum 2 in. wide paper, plastic or fiberglass tape embedded in the first layer of compound over joints in gypsum board.
- D. INSULATION: Install nominal 5-1/2 in. thick, nominal 2.5 pcf density unfaced mineral fiber batt insulation friction fit between the wood studs (Item 1A).
- E. CERTIFIED MANUFACTURER: LP Building Products

CERTIFIED PRODUCT: Wood Sheathing, Fire Retardant Coated Sheathing

MODEL: LP® FlameBlock® Fire-Rated OSB Sheathing

Install nominal 48 in. wide x 96 in. tall, nominal 7/16 in. minimum thick sheathing with the white side facing out. Install sheathing staggered at gypsum seams. Secure sheathing to wood studs (Item 1A) using 1-7/8 in. long 6d nails spaced 6 in. on center around the perimeter and 12 in. on center in the field. Alternatively, use 8d or 10d nails and the same spacing noted previously.

- F. VAPOR BARRIER: Install Tyvek ® HomeWrap ® vapor barrier fastened over the sheathing (Item 1E) using sufficient fasteners to prevent air pockets in the wrap.
2. EXTERIOR WALL COVERING: Install one of the following items on the exterior side of the wall assembly (Item 1):
- A. STEEL SIDING: Install nominal 38-1/2 in. wide x 10 ft long, 26 GA steel siding with minimum 36 in. coverage. Attached siding to wood studs (Item 1A) over the vapor barrier (Item 1E), using 1-7/8 in. long self tapping drywall screws, two per panel per stud.
  - B. T1-11 SIDING: Install minimum 5/16 in. thick plywood or OSB siding per the manufacturer's published installation instructions.
  - C. FIBER CEMENT BOARD: Install minimum 5/16 in. thick cellulose fiber-reinforced cement board per the manufacturer's published installation instructions.
  - D. WOOD FIBER PANEL: Install minimum 5/16 in. thick zinc borate coated wood strand or wood fiber panel per the manufacturer's published installation instructions.

**E. CEMENT PLASTER (STUCCO):**

Install three-coat cement plaster (stucco) over metal lath or wire fabric lath and water resistive barrier as required by the International Building Code (IBC). Alternatively, install Omega Products International, Inc. Omega Diamond Wall or Diamond Wall PM Insulating Exterior Stucco Systems in accordance with manufacturer's installation instructions and with the following requirements:

1. Install a water resistive barrier as required by the IBC for installation over wood based sheathing.
2. Install metal lath or wire fabric lath as required for compliance with the IBC. Fasten lath through the sheathing to the studs with 1-1/4 in. long, 0.125 in. diameter nails having minimum head diameters of 0.355 in. or No. 16 GA, corrosion resistant staples having 15/16 in. crowns. Fasteners spaced 6 in. on center on the studs and perimeter framing.
3. Apply Diamond Wall coating a minimum of 3/8 in. thick in accordance with the manufacturer's instructions.