



# FLAMEBLOCK®

FIRE-RATED OSB SHEATHING



Image courtesy of fig22

## INTERIOR FIRE-RATED WALL ASSEMBLIES



LOOK BENEATH THE IGNITION-RESISTANT PYROTITE COATING AND YOU'LL FIND THE STRENGTH OF LP® OSB.

LP® FLAMEBLOCK® FIRE-RATED OSB SHEATHING FEATURES A PROPRIETARY NON-COMBUSTIBLE, FIBERGLASS-REINFORCED PYROTITE® TREATMENT.

### STRUCTURAL STRENGTH AND CODE COMPLIANCE IN A SINGLE PANEL

LP® FlameBlock® Fire-Rated OSB Sheathing is certified to meet fire code compliance and delivers higher design values than FRT plywood at the same thickness. LP FlameBlock sheathing has the versatility to be used in Type II, III and V construction, and is a listed component in fire-rated interior wall assemblies.

### CODE-APPROVED FIRE-RATED STRUCTURAL SHEATHING

- ICC-certified (ESR-1365)
- 15-minute thermal barrier protection (UBC 26-2)
- 30-minute Class A Flame Spread Rating (ASTM E84, UL723)
- Combination of flame-spread resistance and burn-through resistance
- Code-compliant component of fire-rated interior wall assembly

### DESIGN FLEXIBILITY

Because structural design values for LP FlameBlock sheathing are not reduced by the fire-retardant treatment, the panel carries load/span and shear design values equivalent to an untreated wood structural panel in the same panel thickness category. Using LP FlameBlock sheathing in fire-rated wall assemblies can provide more flexibility in design of wall openings as well as more options in framing and bracing to meet structural requirements.

### STRENGTH

Carries design values for load/span and shear that are superior to fire-retardant treated wood structural panels of the same thickness.

### WEATHER RESISTANCE

Exposure 1 classification certifies that LP FlameBlock sheathing is able to withstand moisture during normal construction delays. Interior-grade FRT plywood must be protected from precipitation during construction.



**INTERIOR ASSEMBLIES CAN  
SIMPLIFY INSTALLATION AND  
INCREASE STRUCTURAL RATINGS**

LP FlameBlock interior assemblies can streamline installation and lower material/labor costs by reducing the need for additional construction materials.

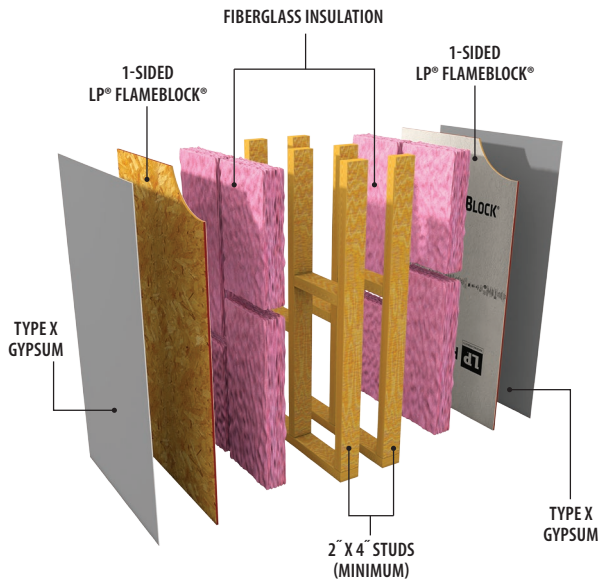

**INTERIOR LOAD-BEARING WALL –  
UL DESIGN NO. U350 (TYPE A)**

(2-HOUR PARTITION WALL; FIRE-RATED ON BOTH SIDES)

- Commonly used in load-bearing partition walls in multifamily construction, including townhomes
- Labor/material cost savings and reduction in dead load due to elimination of a layer of gypsum (vs. WP3820)
- Cost-effective, space-saving alternative to area separation fire walls using Shaft Liner (where code-compliant)
- Sound Transmission Class (STC) rating of 62

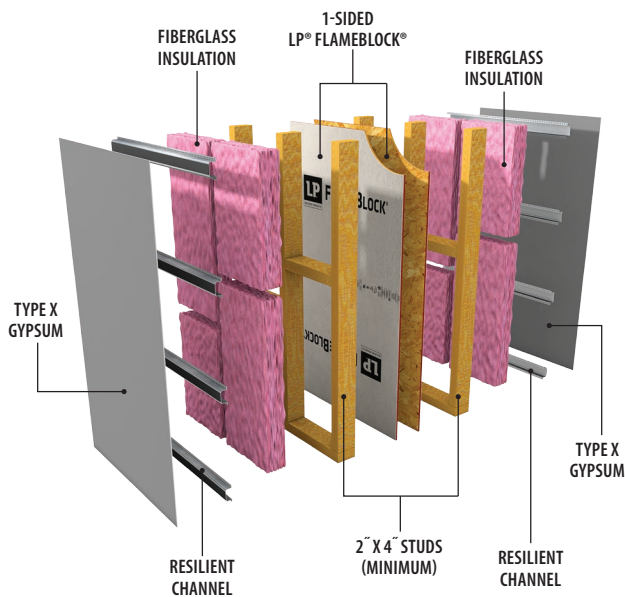

**INTERIOR LOAD-BEARING WALL –  
UL DESIGN NO. U350 (TYPE B)**

(2-HOUR PARTITION WALL; FIRE-RATED ON BOTH SIDES)

- Commonly used in Type III and V 2-hour partition walls in multifamily construction
- Labor/material cost savings and reduction in dead load due to elimination of a layer of gypsum (vs. WP3820)
- Cost-effective, space-saving alternative to area separation fire walls using Shaft Liner (vs. UL375)
- Sound Transmission Class (STC) rating of 62



For more information about LP FlameBlock Fire-Rated OSB Sheathing, including our Technical Guide, call 1-888-820-0325 or visit [LPCorp.com/FlameBlock](http://LPCorp.com/FlameBlock)

LPCorp.com/FlameBlock  
Phone: 1-888-820-0325  
Fax: 1-877-523-7192  
Email: [Customer.Support@LPCorp.com](mailto:Customer.Support@LPCorp.com)

Cal. Prop 65 Warning: Use of this product may result in exposure to wood dust, known to the State of California to cause cancer.

© 2017 Louisiana-Pacific Corporation. All rights reserved. The UL mark is a registered trademark of Underwriters Laboratories, Inc. Sustainable Forestry Initiative and SFI are registered trademarks of Sustainable Forestry Initiative, Inc. Pyrotite is a registered trademark of Barrier Technology, Inc. All other trademarks are owned by Louisiana-Pacific Corporation.