

Louisiana-Pacific Corporation

Design No. LPC/WPPS 60-01

Loadbearing Wall Assembly

LP WeatherLogic® Panel

ASTM E119

Rating: 1 Hour, Restricted to 41% Maximum Design Load

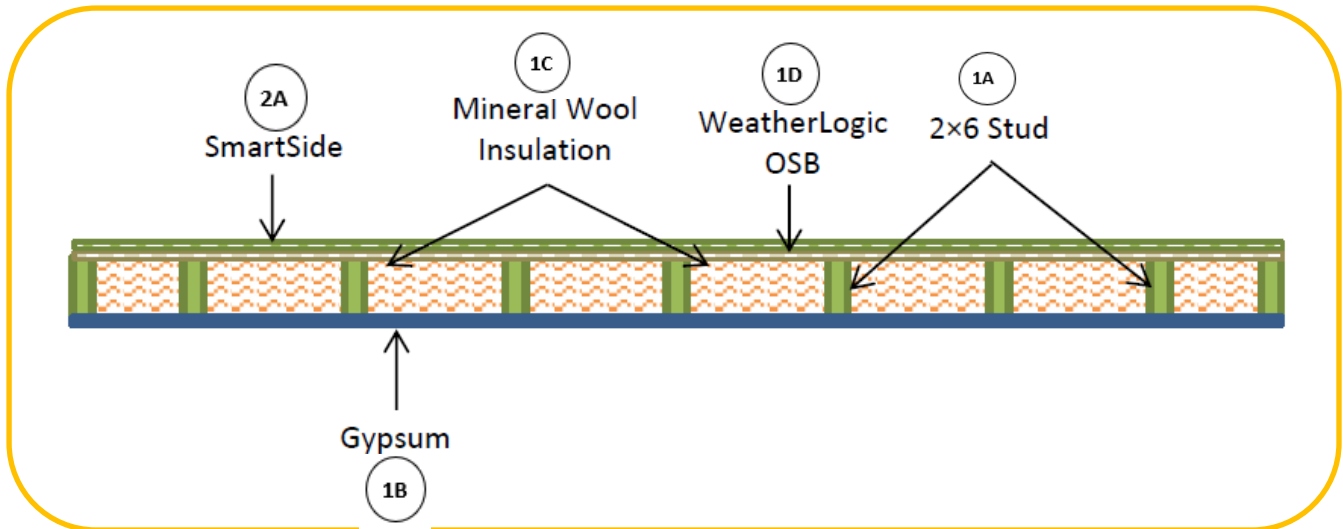

1. WALL ASSEMBLY: Construct a 1 hour rated gypsum wall assembly, with resistance from either side using the following elements:

- A. **WOOD STUDS** – Install 2 × 6 wood studs spaced 16 in. on center (oc). Attached each wood stud to top and bottom wood plates using three 16d framing nails at each location. Full-depth blocking is required at all unsupported panel edges. Construct top plate of two wood studs installed horizontally at the top of the gypsum wall assembly and the bottom plate of a single wood stud.
- B. **GYPNUM BOARD** – Install one layer of nominal 5/8 in. thick Type X gypsum board on interior wall face, oriented vertically. Secure gypsum board using minimum 0.092

in. diameter, 1 7/8 in. long drywall nails spaced 8 in. oc on perimeter and in field.

- C. **INSULATION** – Install nominal 5-1/2 in. thick, nominal 2.8 pcf density unfaced mineral wool insulation friction between the wood studs.

D. OSB SHEATHING

CERTIFIED PRODUCT - LP WeatherLogic® Panels

Install 7/16 Performance Category LP WeatherLogic Panels, oriented vertically, on exterior wall face with 6d nails spaced 6 in. on center on the perimeter and 12 in. oc in the field with 3/8 in. at joint edges.



- E. JOINT TAPE (not shown) – Install one layer of min. 3-3/4 in. wide LP WeatherLogic Seam & Flashing Tape over each joint in LP WeatherLogic Panels.

published installation instructions, including LP SmartSide Lap, LP SmartSide Shake, and LP SmartSide Panel siding.

2. EXTERIOR WALL COVERING: Install one of the following variations of LP® SmartSide® on the exterior face of the wall assembly:

- A. LP SmartSide - Install min. 3/8 in. thick LP SmartSide siding per the manufacturer's

Consult the listing report on the Directory of Building Products (<https://bpdirectory.intertek.com>) for the edition of the standard(s) evaluated.

Compliance of the assembly described in this Design Listing with the referenced standard relies on verification that the assembly constructed in the field is consistent with that described herein. Intertek certified products may be verified by the approved Intertek label; other products must be verified by the Authority Having Jurisdiction as meeting the specifications stated herein.