

Louisiana-Pacific Corporation
Design No. LPC/WPPS 60-02
Loadbearing Wall Assembly
LP WeatherLogic® OSB Sheathing
ASTM E119
Rating: 1 Hour, Load Bearing 100% Design Load

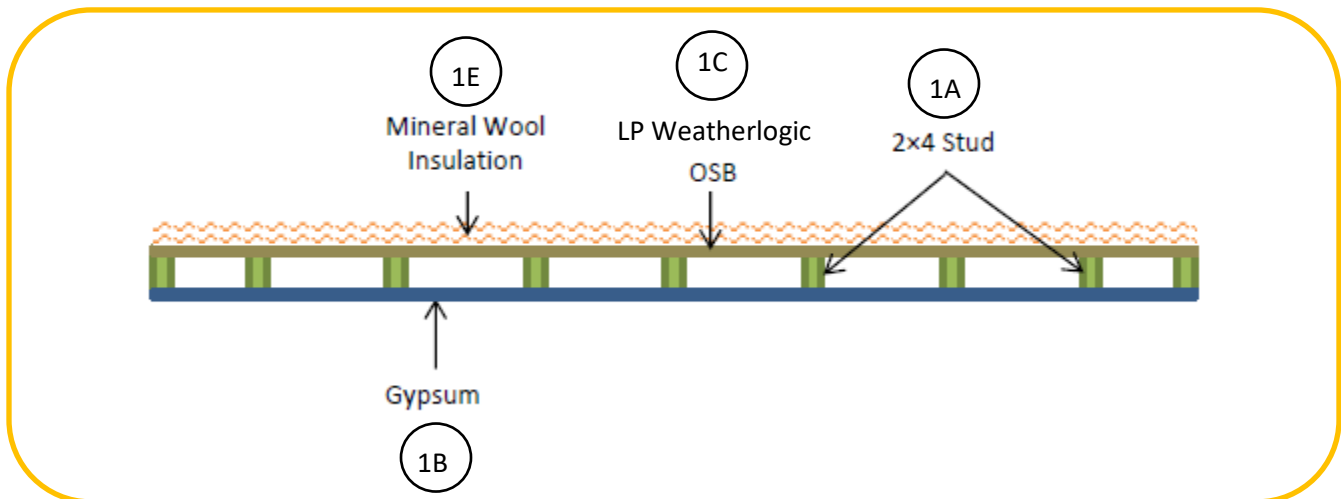

1. WALL ASSEMBLY: Construct a 1 hour rated gypsum wall assembly using the following elements:

- A. **WOOD STUDS** – Install nominal 2 × 4 wood studs spaced 16 in. on center (oc). Attach each wood stud to top and bottom wood plates using two 16d framing nails at each location. Construct top plate of two wood studs installed horizontally at the top of the gypsum wall assembly and the bottom plate of a single wood stud. Include blocking at all horizontal unsupported panel edges.
- B. **GYPSUM BOARD** – Install one layer of nominal 5/8 in. thick, 4 ft. wide Type X gypsum board on the unexposed wall face, oriented vertically. Secure gypsum board using 6d cup-head nails spaced 8 in. oc on perimeter and in field with 3/8 in. at joint edges. Coat joints and nail heads with two layers of joint compound.

C. **SHEATHING** –

CERTIFIED PRODUCT – Louisiana-Pacific Corporation, LP WeatherLogic® OSB Sheathing

Install nominal 48 in. wide × 120 in. tall, nominal 7/16 in. thick LP® WeatherLogic on exposed wall face vertically with 6d nails spaced 6 in. oc on the perimeter and 12 in. oc in the field with 3/8 in. at joint edges.

- D. **JOINT TAPE** (not shown) – Install one layer of min. 3-3/4 in. LP WeatherLogic Seam and Flashing Tape over each vertical joint.
- E. **EXTERIOR INSULATION** – Install nominal 2 in. thick, nominal 6.8 pcf density, 2 ft. × 4 ft. Owens Corning Thermafiber RainBarrier HD horizontally with a continuous vertical joint with an 8 in. stagger from the studs.



Fasten each board with six 3-1/2 in. #10 exterior wood screws, three fasteners each along the top and bottom of the board, spaced 3 in. from the joint.

Consult the listing report on the Directory of Building Products (<https://bpdirectory.intertek.com>) for the edition of the standard(s) evaluated.

Compliance of the assembly described in this Design Listing with the referenced standard relies on verification that the assembly constructed in the field is consistent with that described herein. Intertek certified products may be verified by the approved Intertek label; other products must be verified by the Authority Having Jurisdiction as meeting the specifications stated herein.