

## Installing LP® CanExel® Ced'R-Vue® Prefinished 6" Snap Lap Siding

---

This Technical Note is an addendum to the LP® CanExel® Ced'R-Vue® Prefinished Lap Siding Installation Instructions ("Instructions"). It is intended to provide an alternative fastening option for LP CanExel Ced'R-Vue® Prefinished 6" Snap Lap Siding. The Instructions remain effective except as may be modified by this Note. Refer to the Instructions for all other aspects of product installation.

### LP CanExel Ced'R-Vue Prefinished 6" Snap Lap Siding:

- Siding must be installed horizontally over sheathing or unsheathed walls and nailed in studs spaced not more than 406 mm (16 inches) o.c.
  - Sheathing must be a minimum 7/16 Category wood structural panels with an APA Trademark that contains the consensus Standard DOC PS 1 or PS Exception: LP FlameBlock® Fire-Rated OSB Sheathing
- Siding must be applied over a code compliant sheathing membrane meeting or exceeding CAN/CGSB-51.32-M "Sheathing, Membrane, Breather Type"<sup>1</sup>
- In QC and coastal provinces (NFLD, NS, NB, PEI, BC) siding must be applied on furring strips ("strapping")
- Strapping:
  - Must be installed vertically and nailed in studs spaced not more than 406 mm (16 inches) o.c. over the full height of the wall
  - Must not be less than 6.35 mm (1/4 inch) thick
  - Spaced maximum of 406 mm (16 inches) on center
  - To ensure ventilation, both the top and bottom of the space between strapping must be left open.
  - At the bottom of the wall, a short piece of strapping about 305 mm (12 inches) long should be installed vertically, centered between each main piece of strapping. This will provide better support and will ensure that the insect screen fills the opening.
  - The opening at the bottom of the wall should be open to the outside except for the insect screen.
  - Under and above windows and doors maintain spacing of 51 mm (2 inches) between strapping and the horizontal framing (*See Figure 3*)

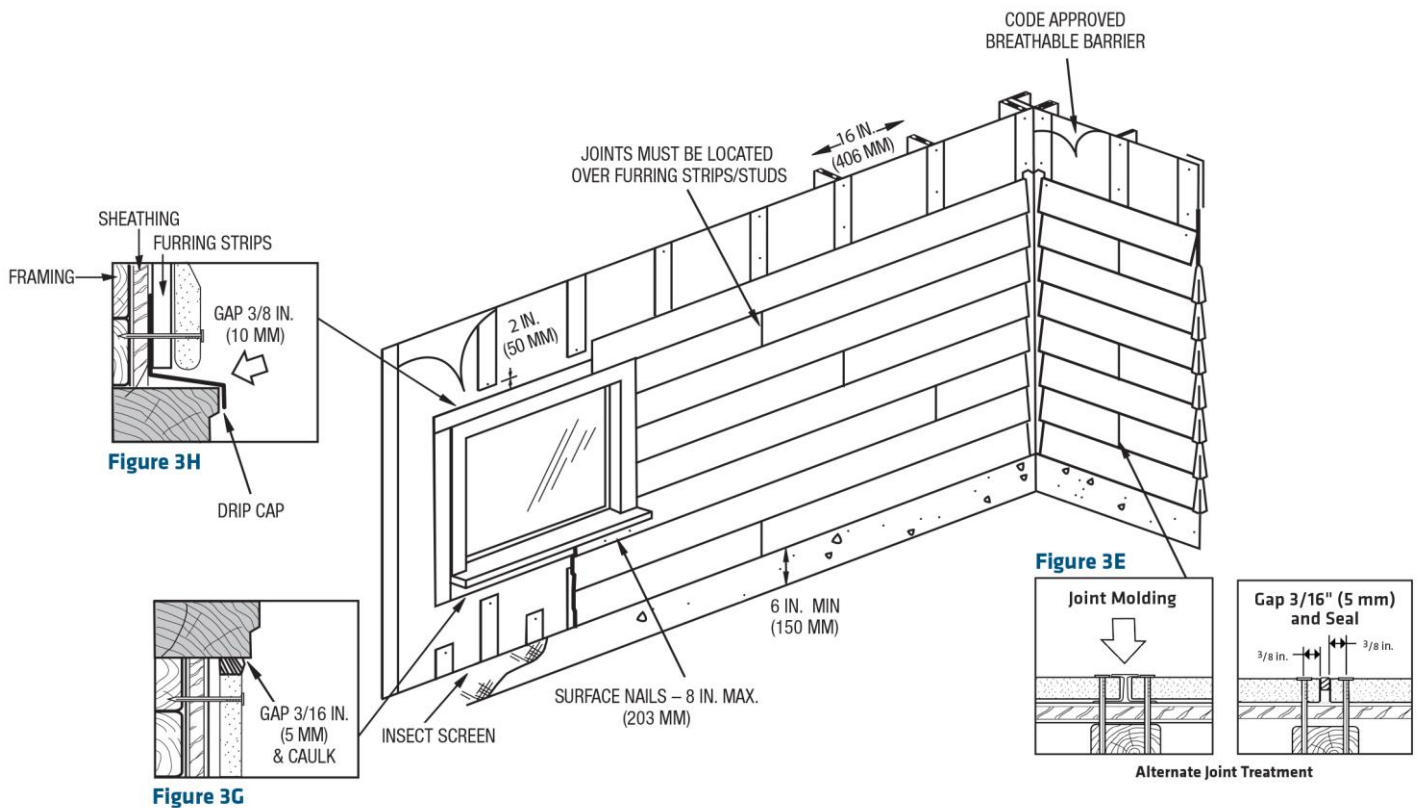

**Figure 3**

- Level and install metal starter strip along bottom edge of wall sheathing or sill plate, or up to 25 mm (1 inch) below these, as required by course layout. A wood starter strip, equal to the sidings thickness, can be substituted for metal starter strip.
- Wall flatness will be controlled by stud straightness, sheathing installation, and furring strip installation
- Minimum Fastener Type for Ced'R-Vue 6" Snap Lap:
  - Corrosion Resistant – Hot-dipped galvanized (ASTM A153) or stainless steel
  - Smooth Shank
  - Shank diameter = 2.870 mm (0.113 inch)
  - Head diameter = 6.096 mm (0.240 inch)
  - Length = minimum 31.75 mm (1.25 inches) of penetrate into stud, strapping, or combination of both
- Alternate Fastener Type for Ced'R-Vue 6" Snap Lap:
  - Corrosion Resistant = Hot-dipped galvanized (ASTM A153) or stainless steel
  - Spiral Shank
  - Shank diameter = 2.870 mm (0.113 inch)

- Head diameter = 6.096 mm (0.240 inch)
  - Length = minimum 28.575 mm (1.125 inches) of penetrate into stud, strapping, or combination of both
- Fastener placement for Ced'R-Vue 6" Snap Lap:
  - Place fasteners 19.05 mm (3/4 inch) from top edge of lap siding
  - Place fasteners 9.525 mm (3/8 inch) from ends of lap siding
- Placement of Ced'R-Vue 6" Snap Lap:
  - A minimum 4.763 mm (3/16 inch) space is required at ALL vertical joints<sup>2</sup>
  - A minimum 4.763 mm (3/16 inch) space is required where siding butts against trim or other material to allow for expansion
- Blind nailing is required, except around windows and other wall openings.
  - Space nails 203 mm (8 inches) o.c. along edge of siding under windows
- Joints must occur over studs
- If joint caulking option is selected, seal all gaps at vertical joints<sup>2</sup> with a high-quality exterior sealant meeting the ASTM C920, minimum Class 25 sealant
- If joint moulding option is selected, add the thickness of the web to the gap allowing a net 4.763 mm (3/16 inch) space for expansion
- Finish/Paint:
  - Prime and paint all field cuts and exposed ends or edges following the paint manufacturer's instruction
- A vapor barrier with a perm rating less than 1 must be installed on the warn side or interior surface of the wall
- Ensure that the wall assembly meets at least the minimum structural requirements specified in the National Building Code of Canada and by the local code authority
- Ced'R-Vue 6" Snap Lap must be separated ("snapped") on flat surface or the sacrificial horizontal line will not easily or cleanly snap. For best results snap the siding on flat surface made using a few sawhorses and two 2x12's equal to the length of the siding.

The provisions and terms of this Technical Note are limited to structures permanently located in the Canada and apply exclusively to LP<sup>®</sup> CanExel<sup>®</sup> Ced'R-Vue<sup>®</sup> Prefinished 6" Snap Lap Siding manufactured by Louisiana-Pacific Canada Limited, East River plant ("LP Canada").

<sup>1</sup>Siding must be applied over a code compliant water-resistive barrier (WRB) meeting or exceeding ASTM E2273

<sup>2</sup>Butt joints